

## PORCELAIN PIN POST INSULATOR

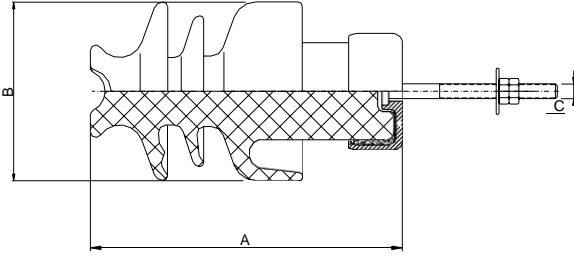

Fig 1

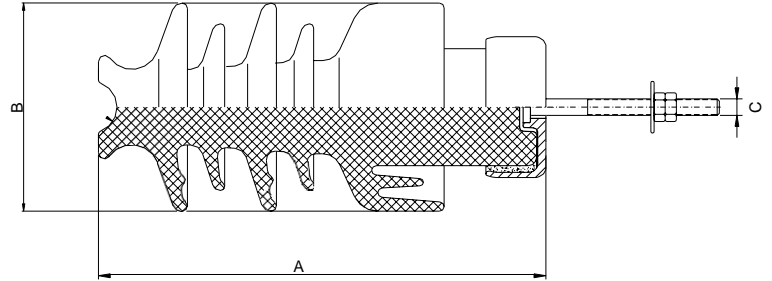

Fig 2

### STANDARD PARTICULARS

Cat. No.			0301025-4	0301035-4	0301045-4
Fig No.			1	1	2
Usual line voltage/kV			11	24	36
Designation of Neck			F	F	F
Height "A" (mm)			222	336	432
Diameter "B"(mm)			146	175	205
Stud Diameter "C" (mm)			M20	M20	M20
Min. leakage distance (mm)			350	530	875
Dry arcing distance/in(mm)			165	311	368
Cantilever strength/lb(kN)			12.5	12.5	12.5
Average flashover voltage	Low Frequency	Dry/kV	80	110	150
		Wet/kV	60	85	125
	Critical Impulse	Pos. /kV	130	210	255
		Neg. /kV	155	260	340
Withstand voltage	Low frequency	Dry/kV	60	85	120
		Wet/kV	45	65	100
	Impulse/kV		110	180	200
Radio Influence voltage data	Test voltage/kV		15	24	36
	Max. RIV at 1,000kHz/uV		100	200	200
Net weight (kg)			5	10	16